

TR Hank® Rivet Bushes Swage Nut (XX)

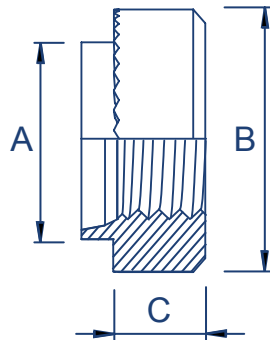

Steel/Zinc & Clear (TC1) | Steel/Self Finish (SF) | Stainless Steel/Self Finish (SF)

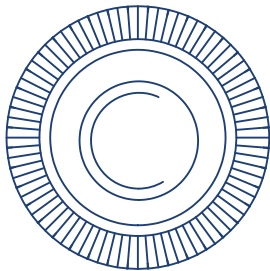

Metric Dimensions

Thread		M3	M4	M5	M6	M8
Diameter of spigot +0.00 -0.13mm	A	4.24	5.38	6.35	8.70	10.44
Body diameter ±0.15mm	B	6.35	7.92	8.70	11.20	12.65
Depth of body ±0.13mm	C	1.5	2.0	2.0	4.0	5.5
Recommended hole size +0.05 -0.00mm		4.25	5.40	6.40	8.75	10.50

Imperial/Unified Dimensions

Thread		4 UNC	6 UNC	8 UNC	10 UNC	1/4" UNC	5/16" UNC
Diameter of spigot +0.000" -0.005"mm	A	0.165	0.187	0.212	0.250	0.343	0.411
Body diameter ±0.010"	B	0.250	0.280	0.312	0.343	0.440	0.5
Depth of body ±0.005"	C	0.070	0.070	0.090	0.090	0.170	0.23
Recommended hole size +0.002" -0.000"		0.166	0.188	0.213	0.251	0.344	0.413

All Imperial/Unified sizes are non-preferred - please enquire for availability

Other materials and finishes are available upon request

All data is correct to the best of our knowledge, however TR cannot be held responsible for any errors or omissions.